

**TITLE XV UNIFIED DEVELOPMENT CODE
CHAPTER 172: PARKING AND LOADING**

172.01 PURPOSE..... 3

172.02 PARKING LOT CONSTRUCTION STANDARDS 3

172.03 ACCESSIBILITY 3

172.04 PARKING LOT DESIGN STANDARDS..... 4

172.05 STANDARDS FOR THE NUMBER OF SPACES BY USE 7

172.06 PARKING LOT LOCATION STANDARDS..... 10

172.07 RESERVED 11

172.08 NONCONFORMING PARKING LOTS..... 11

172.09 OFF-STREET LOADING 11

172.10 BICYCLE PARKING RACK REQUIREMENTS 12

172.11 DRIVEWAY DESIGN, LOCATION, AND CONSTRUCTION STANDARDS FOR FOUR (4) OR
LESS SPACES PARKING SPACES WITHIN THE FRONT YARD AREA 14

172.12-172.99 RESERVED 15

CHAPTER 172: PARKING AND LOADING

172.01 Purpose

The regulations of this section are intended to reinforce community standards and to promote safe and attractive parking lots for new, redeveloped, and expanded development within the city. The size, number, design, landscaping, and location of parking lots are regulated in order to:

- (A) Provide for the safe and orderly circulation of motor vehicles within parking lots;
- (B) Provide safe ingress and egress to parking lots from public and private streets;
- (C) Protect adjoining properties from the adverse impacts associated with parking lots such as noise, lighting, appearance, drainage, and effect on property values;
- (D) Provide adequate areas for off-street parking and storage of motor vehicles, while at the same time preventing over-supply of parking in mixed-use circumstances; and,
- (E) Enhance the appearance of parking lots in all zoning districts.

172.02 Parking Lot Construction Standards

- (A) *Permits and plan.* For parking lots containing five (5) or more spaces, building, and grading permits and site and grading plans shall be required prior to any initiation of work.
- (B) *Surfacing.* Parking lots shall be asphalt, semi-permeable soil pavers, or concrete, graded and drained to dispose of surface water into appropriate structures.
- (C) *Barriers.* Parking lots shall be provided with wheel guards or curbs so located that no part of a parked vehicle will extend into or over the sidewalks, property lines, or street right-of-way.
- (D) *Striping and marking.* Parking lots spaces shall be striped to indicate the location of the individual spaces, directional arrows shall be provided at the entrance of aisles and entry drives, and accessible spaces shall be marked meeting current Americans with Disabilities Act (ADA) requirements. Such striping and marking shall be in accordance with the Manual on Uniform Traffic Control Devices.

172.03 Accessibility

- (A) *ADA reference.* Accessibility for persons with disabilities in parking lots and building approaches shall be as required by the current ADA and as may from time to time be amended.
- (B) *Location and size.* Location and minimum stall size of accessible parking spaces, passenger loading zones, or valet parking facilities, when provided for public or governmental buildings and facilities, shall meet the standards adopted in the ADA.
- (C) *Buildings.* Accessibility guidelines (ADAAG) for buildings and facilities, Appendix A to 28 C.F.R. Part 36, or the current federal standard.
- (D) *Signage.* Accessible parking spaces for persons with disabilities shall be identified with signs in accordance with the current federal statute of the Americans with Disabilities Act (ADA). Curb ramps shall be provided in accordance with the Americans with Disabilities Act (ADA) wherever an accessible route crosses a curb in the parking lot.
- (E) *Minimum number of accessible spaces.* The following table shall be used to determine the minimum number of accessible parking spaces to be provided for persons with disabilities:

Total parking spaces in lot or garage	Minimum number of accessible spaces
1—25	1
26—50	2
51--75	3
76--100	4
101--150	5
151--200	6
201--300	7
301--400	8
401--500	9
501--1000	2% of total spaces
Over 1000	20 spaces + 1 space for each 100 spaces over 1000

- (F) *Facilities providing medical care.* Facilities providing medical care and other services for persons with mobility impairments shall provide accessible parking spaces as follows:
 - (1) *Outpatient facilities.* Outpatient units and facilities shall provide a minimum of 10% of the total number of parking spaces provided serving each such outpatient unit or facility, but in no event shall less than one such parking space be provided.

Fayetteville Code of Ordinances

(2) *Specialized facilities.* Units and facilities that specialize in treatment or services for persons with mobility impairments shall provide 20% of the total number of parking spaces provided serving each such unit or facility, but in no event shall less than one such parking space be provided.

(G) *Multi-family dwellings.* Multi-family dwellings containing four (4) or more dwelling units shall provide accessible parking spaces as follows:

(1) *Fair Housing Act reference.* Accessible parking shall be provided which meets the provision in the Final Housing Accessibility Guidelines, 24 C.F.R., Chapter 1, Subchapter A, Appendix II, of the Fair Housing Act of 1968, as amended, or the current federal standard.

(2) *Number of required accessible space.* Designated accessible parking shall be provided for at least two (2) percent of the dwelling units and at facilities such as swimming pools and clubhouses that serve accessible buildings. Additional designated accessible parking shall be provided on request of residents with disabilities, on the same terms and with the full range of choices that are provided for other residents of the development.

(3) *Visitor parking.* Accessible visitor parking that provides sufficient access to grade level entrances of multi-family dwellings is also required.

(Ord. 5297, 12-15-09)

172.04 Parking Lot Design Standards

(See: Illustration: Parking Dimension Factors)

(A) *Maneuvering.* Parking lots shall be designated, maintained, and regulated so that no parking or maneuvering incidental to parking will encroach into the areas designated for sidewalks, streets, or required landscaping except as provided for in §172.07(B)(2). Parking lots shall be designed so that parking and unparking can occur without moving other vehicles. Vehicles shall exit the parking lot in a forward motion.

(B) *Pedestrian access.* Pedestrian access shall be provided from the street to the entrance of the structure by way of designated pathway or sidewalk.

(C) *Build-to zone.* No portion of any parking lot shall be located in a build-to zone.

(D) *Compact spaces.* A maximum of 35% of the total spaces may be compact spaces. Compact spaces shall be marked either by marking on the pavement or by separate marker.

(E) *Dimensional requirements.* (See Table 1)

TABLE 1
DIMENSIONAL REQUIREMENTS

Angle (A)	Type	Width (in ft.) (B)	Curb length (in ft.) (C)	One-way aisle width (in ft.) (D)	Two-way aisle width (in ft.) (D)	Stall depth (in ft.) (E)
0°	Standard	8	22.5	12	24	8
Parallel	Compact	7.5	19.5	12	24	7.5
30°	Standard	9	18	12	24	17
	Compact	7.5	15	12	24	14
45°	Standard	9	12.5	12	24	19
	Compact	7.5	10.5	12	24	16
60°	Standard	9	10.5	18	24	20
	Compact	7.5	8.5	15	24	16.5
90°	Standard	9	9	24	24	19
	Compact	7.5	7.5	22	24	15

TITLE XV. UNIFIED DEVELOPMENT CODE

Motorcycle/Scooter	3	3	12-24	24	7.5 - 9
--------------------	---	---	-------	----	---------

DIMENSIONAL FACTORS

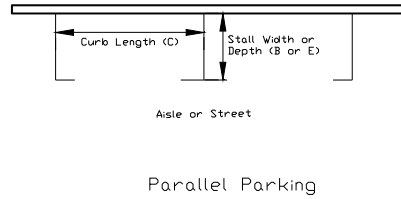
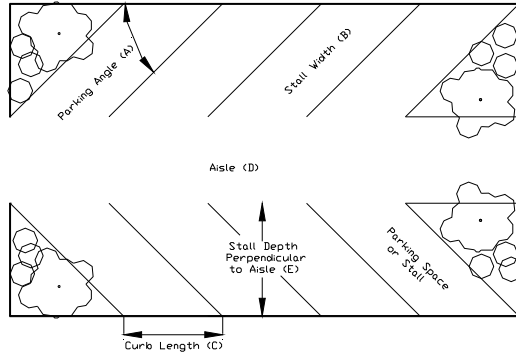

(F) Parking Lot Circulation.

(1) *Throat length.* The length of driveways or "throat length" shall be designed in accordance with the anticipated storage length for vehicles to prevent them from backing into the flow of traffic on the public street or causing unsafe conflicts with on-site circulation. General standards appear below, but these requirements may vary according to the project volume of the individual driveway. These measures generally are acceptable for the principal access to a property and are not intended for minor driveways. Variation from these standards may be permitted for good cause upon approval of the Zoning and Development Administrator and City Engineer.

shopping plazas, need much greater throat length than smaller developments or those with unsignalized driveways. The guidelines here for larger developments refer to the primary access drive. Reduced throat lengths may be permitted for secondary access drives serving large developments.

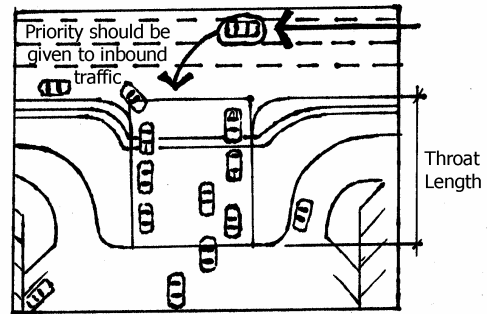

TABLE 2
GENERALLY ADEQUATE
DRIVEWAY THROAT LENGTHS

Shopping Centers (Signalized)	>200,000 GLA* (800) spaces	200 ft.
Smaller Developments (Signalized)	<200,000 GLA*	75-95 ft.
Unsignalized Driveways	--	40-60 ft.

*GLA-Gross leaseable area

Commentary. The throat lengths in Table 2 are provided to assure adequate stacking space within parking lot driveways for general land use intensities. This helps prevent vehicles from stacking into the thoroughfare as they attempt to enter the parking lot. High traffic generators, such as large

(2) Drive-through facilities. All uses that include a drive-up window or are characterized by patrons remaining in their vehicles to receive service shall meet the following on-site stacking requirements in order to alleviate traffic congestions:

- (a) Restaurant, fast food: a minimum of four (4) spaces as measured from the drive-thru window
- (b) Vehicular washes: a minimum of two (2) spaces per car wash bay as measured from the bay.
- (c) Pharmacies and financial institutions: a minimum of four (4) spaces for one (1) drive-thru window, plus three (3) spaces for each additional drive-thru lane or automated teller machine (ATM), as measured from each drive-thru window.

Fayetteville Code of Ordinances

- (d) Dry cleaning and laundry services: a minimum of two (2) spaces as measured from the drive-thru window.
- (3) *Entrances and internal aisle design for parking lots containing 8 parking spaces or less.* The driveway width into parking lots shall meet the following requirements:

(a) *Entrances.*

- (i) *One-way access to parking lots.* If the driveway is a one-way in or one-way out, then the driveway width shall be a minimum of 12 feet and a maximum of 16 feet. Parking lots shall not be located more than 100 feet from the street right-of-way. Commercial solid waste service is required.
- (ii) *Two-way access to parking lots.* For two way access, the driveway width shall be a minimum of 12 feet and a maximum of 24 feet. Parking lots shall not be located more than 100 feet from the street right-of-way. This standard shall only apply when a 2 yard dumpster is allowed.
- (iii) *Driveway width requirements for parking lots located 100 feet or more from the street right-of-way.* Two drive lanes a minimum width of 10 feet each, up to a maximum combined width of 24 feet, shall be required for adequate parking lot access.
- (iv) *Curb radius.* All driveway entrances serving 8 or less parking spaces shall have a minimum curb radius of 10 feet and a maximum of 20 feet.

(b) *Internal aisle design.*

- (i) Aisles shall be designed so that they intersect at 90 degrees with other aisles and driveways where practical.
- (ii) Aisles shall be designed to discourage cut-through traffic by use of landscape islands, and shall meet the requirements of Chapter 177: Landscape Regulations.
- (iii) Aisles shall conform to the dimensional requirements of §172.04(C).

(c) *Variiances.* Development proposals which do not meet these standards may apply for a variance from these requirements subject to Planning Commission approval.

Parking Lots With 8 Spaces or Less	
	Driveway Dimensional Requirement
One Way Access <100'	12' Minimum – 16' Maximum
Two Way Access <100'	12' Minimum - 24' Maximum
>100' Driveway Length	2 Drive Lanes 10' Minimum Each – 24' Maximum Total Driveway Width
Curb Radius	10' Minimum – 20' Maximum

- (4) *Entrances and internal aisle design for parking lots containing 9 or more parking spaces.* The driveway width into parking lots shall meet the following requirements:

(a) *Entrances.*

- (i) *One-way access to parking lots.* If the driveway is a one-way in or one-way out, then the driveway width shall be a minimum of 12 feet and a maximum of 16 feet.
- (ii) *Two-way access to parking lots.* For two way access, the driveway width shall be a minimum 20 feet and a maximum width of 24 feet, unless otherwise required by the Fire Department.
- (iii) *Collector and Arterial Streets.* Driveways that enter collector and arterial streets may be required to have two outbound lanes (one for each turning direction) and one inbound lane for a maximum total driveway width of 39 feet.
- (iv) *Curb radius.* All driveways serving 9 or more parking spaces shall have a curb radius of 15 feet for curb cuts on local streets and a curb cut radius of 20 feet for collector, minor arterial and arterial streets.

(b) *Internal aisle design.*

- (i) Aisles shall be designed so that they intersect at 90 degrees with other aisles and driveways where practical.
- (ii) Aisles shall be designed to discourage cut-through traffic by use of landscape islands, and shall meet the requirements of Chapter 177: Landscape Regulations.

(iii) Aisles shall conform to the dimensional requirements of §172.04(C).

(c) *Waivers.* Development proposals which do not meet these standards may apply for waiver from these requirements subject to Planning Commission approval.

Parking Lots With 9 Spaces or More	
	Driveway Dimensional Requirement
One Way Access	12' Minimum – 16' Maximum
Two Way Access	2 Drive Lanes 10' Minimum Each – 24' Maximum Total Driveway Width
Collector/Arterial Streets	3 Drive Lanes - Maximum of 39'
Curb Radius - Local	15'
Curb Radius - Collector/ Arterial	20'

(G) *Hillside/Hilltop Overlay District.*

- (1) *Separation of Parking Pads in Multi-Family, and Non-Residential Development.* Parking pads shall be separated by a minimum undisturbed area of 15 feet between parking pads. Streets and access drives are permitted to cross this undisturbed area.
- (2) *Cut and Fill Slopes.* Parking pads should be encouraged to utilize cut slopes with retaining walls to minimize disturbance.
- (3) *Maximum number of spaces per parking lot for multi-family and non-residential uses.* Parking pads shall have a maximum of 30 spaces per pad.
- (4) *Parking lot location.* Parking lots shall be set back with a minimum of 35' of undisturbed area required adjacent to the street right-of-way.
- (5) *Multifamily and non-residential uses.* Developers of multi-family and non-residential uses in the Hillside Overlay District are encouraged to refer to the Hillside Best Management Practices Manual for guidance and direction in the design of their project.

(Ord. 4725, 7-19-05; Ord. No. 4855, 4-18-06; Ord. No. 4917, 9-05-06; Ord. 5044, 8-07-07; Ord. 5079, 11-20-07; Ord. 5297, 12-15-09)

172.05 Standards For The Number Of Spaces By Use

(A) *Required parking.*

(1) *Required number of spaces.* A proposed use shall conform to the established parking ratios listed in Table 3. The minimum number of spaces required for a use not specifically included in this section shall be as required for the most similar use listed or as otherwise determined by the Planning Division utilizing reference standards. For all parking space requirements resulting in a fraction, the fraction shall be:

- (a) rounded to the next higher whole number when the fraction is 0.5 or higher.
- (b) rounded to the next lower whole number when the fraction is less than 0.5.

(2) *Change of use - existing structure.* A change of use in an existing structure may be permitted if the use adequately meets the minimum parking ratio standards herein. A change of use shall not be penalized for existing parking spaces that exceed the required parking ratios included in this chapter.

(3) *Change of use – waiver.* In Downtown Core, Main Street Center, and Downtown General zoning districts, parking requirements are waived for any existing structure with a change of use. New construction, razed buildings or enlarged buildings shall conform to the parking requirements of the City of Fayetteville. For enlarged buildings, additional parking spaces will be calculated by the amount of square footage that is added.

(4) *Building footprint – waiver.* In Downtown Core, Main Street Center and Downtown General zoning districts, parking requirements are waived for the square footage "footprint" of any building which existed and has been removed since October 1, 1995, in order to rebuild.

(5) *Downtown Core, Main Street Center, and Downtown General Zoning Districts accessory outdoor use areas -* Accessory outdoor patios, balconies, decks, and other similar outdoor use areas for restaurants and bars shall be exempt from meeting off-street parking requirements in the *Downtown Core, Main Street Center, and Downtown General* zoning districts.

Fayetteville Code of Ordinances

TABLE 3
PARKING RATIOS
(Use/Required Spaces)

Residential

Single-family, duplex, triplex	2 per dwelling unit
Multi-family or townhouse	1 per bedroom

Commercial

Agricultural supply	1 per 500 sq. ft. of GFA
Amusement	1 per 200 sq. ft. of GFA
Auditorium	1 per 4 seats
Auto/motorcycle service stations	4 per each enclosed service bay
Bank	1 per 200 sq. ft. of GFA
Barber or beauty shop	2 per chair
Building/home improvement supply	1 per 500 sq. ft. of GFA
Coin-operated laundry	1 per 3 machines
Dry cleaning	1 per 300 sq. ft. of retail area and 1 per employee
Hotels and motels	1 per guest room, plus 75% of spaces required for accessory uses.
Furniture and carpet store	1 per 500 sq. ft. of GFA
Plant nursery	1 per 1,000 sq. ft of indoor/outdoor retail area
Restaurants	1 per 100 sq. ft. GFA plus 4 stacking spaces per drive-thru window.
Retail	1 per 250 sq. ft. of GFA
Retail fuel sales with convenience stores	1 per 200 sq. ft. of retail FA; spaces at pump islands are counted toward this requirement
Retail fuel sales only	3 per each employee; spaces at pump islands are counted toward this requirement

Office

Medical/Dental office	1 per 250 sq. ft. of GFA
Professional office	1 per 300 sq. ft. of GFA
Sales office	1 per 200 sq. ft. of GFA

Public and Institutional Uses
 Nonprofit Commercial

Art gallery, library, museum	1 per 1,000 sq. ft. of GFA
Auditorium	1 per 4 seats, provided only auditorium space is counted in determining parking
Child care center, nursery school	1 per employee plus on-site loading and unloading spaces at a rate of 1 per 10 children accommodated
Church/religious institution	1 per 4 seats in the main auditorium or 1 per 40 sq. ft. of assembly area, whichever provides more spaces
College auditorium	1 per 4 seats
College dormitory	1 per sleeping room
College or university	1 per 500 sq. ft. of classroom area
Community center	1 per 250 sq. ft. of GFA
Cooperative housing	1 per 2 occupants

Convalescent home, assisted living, nursing home	1 per 2 beds
Detention home	1 per 1,500 sq. ft. of GFA
Elderly Housing	1 per 2 units
Funeral homes	1 per 4 seats in main chapel plus 1 per 2 employees plus 1 reserved for each vehicle used in connection with the business
Government facilities	1 per 500 square feet of floor area
Hospital	1 per bed
Convalescent home	1 per bed
School--elementary and junior high	1 per employee plus 1 space per classroom
School--senior high	1 per employee plus 1 per 3 students based on design capacity, or 1 per 6 seats in auditorium or other places of assembly, whichever is greater
Zoo	1 per 2,000 sq. ft. of land area
All other public and institutional uses (only auditorium space shall be counted for churches, auditoriums, or group occupancy space)	1 per 4 occupants

Manufacturing/Industrial

Manufacturing	1 per 1,200 sq. ft. of GFA or one per employee, whichever is greater
Heavy industrial	1 per 1,200 sq. ft. of GFA
Extractive uses	Adequate for all employees, trucks, and equipment

Recreational Uses

Amusement park, miniature golf	1 per 1,000 sq. ft. of site area
Bowling alley	6 per lane
Commercial recreation	1 per 200 sq. ft. of GFA
Commercial recreation-large sites	1 per 1,000 sq. ft. of site area
Dance hall, bar or tavern	1 per 50 sq. ft. of GFA, excluding kitchen
Golf course	3 per hole
Golf driving range	1 per tee box
Health club, gym	1 per 150 sq. ft. of GFA
Regional or community park	2 per acre of accessible active and passive space
Neighborhood park	None
Private club or lodge	1 per 500 sq. ft. of GFA or 1 per 3 occupants based on the current adopted Standard Building Code whichever is greater
Riding stable	1 per acre; not required to be paved
Tennis court	2 per court
Theater	1 per 4 seats
All other recreational uses	1 per 4 occupants

Warehousing and Wholesale

TITLE XV. UNIFIED DEVELOPMENT CODE

Warehousing	1 per 2,000 sq. ft. of GFA
Wholesale	1 per 1,000 sq. ft. of GFA
Center for collecting recycled materials	1 per 1,000 sq. ft. of GFA

(B) *On-street parking.* Permitted on-street parking spaces adjacent to a project frontage may count toward the parking requirements for all development, subject to approval by the Zoning and Development Administrator. Each on-street parking space provided may count toward the total required parking spaces for the development.

(C) *Off-street parking.*

(1) *Motorcycle and scooter parking.* In parking lots containing 25 parking spaces or more, one (1) space for every 25 parking spaces of the required number of parking spaces for a use or combination of uses shall be striped as a motorcycle and scooter parking space.

(2) *Maximum number allowed.* Developments may utilize the following increases to the required spaces listed in Table 3 when the following standards are met:

(a) Developments may increase the number of off-street parking spaces by 15% above the parking ratios listed in Table 3.

(b) Developments may increase the number of off-street parking spaces by an additional 10% when alternative stormwater treatment techniques are utilized, such as:

- (i) Bioswales
- (ii) constructed wetlands
- (iii) pervious pavement
- (iv) other such techniques that aid in improving water quality and quantity as approved by the City Engineer

(c) Developments may increase the number of off-street parking spaces by an additional 5% when one (1), two-inch (2") caliper tree for every 10 additional parking spaces is planted on-site in addition to all other landscaping requirements.

(3) *Reductions.* Developments may utilize the following reductions to the required off-street parking ratios listed in Table 3 when the following standards are met:

(a) *Transit stops.* Properties located within a quarter (0.25) mile radius of a transit stop may further reduce the minimum off street parking requirements by up to fifteen percent (15%).

(b) *Motorcycle and scooter spaces.* Up to 10% of the required automobile parking spaces may be substituted with motorcycle/scooter parking at a rate of one motorcycle/scooter space for one automobile space.

(c) *Bike racks.* Up to 10% of required automobile parking may be substituted with bicycle parking at a rate of one additional bicycle rack for one automobile space. This reduction shall be allowed in addition to other variances, reductions and shared parking agreements.

(d) *Shared parking.* Parking requirements may be shared where it can be determined that the peak parking demand of the existing or proposed occupancy occur at different times (either daily or seasonally). Such arrangements are subject to the approval of the Planning Commission.

(i) *Shared parking between developments.* Formal arrangements that share parking between intermittent uses with nonconflicting parking demands (e.g. a church and a bank) are encouraged as a means to reduce the amount of parking required.

(ii) *Shared parking agreements.* If a privately owned parking facility is to serve two or more separate properties, then a "Shared Parking Agreement" is to be filed with the city for consideration by the Planning Commission.

(iii) *Shared spaces.* Individual spaces identified on a site plan for shared users shall not be shared by more than one user at the same time.

(e) *Reduced parking within mixed use developments.* Parking requirements may be reduced where it can be determined that the peak parking demand of the existing or proposed occupancy occur at different times (either daily or seasonally). Such

Fayetteville Code of Ordinances

arrangements are subject to the approval of the Planning Commission.

(i) *Request for parking space reduction.* A shared parking plan must be prepared to the satisfaction of the Planning Commission showing that parking spaces most conveniently serve the land uses intended, directional signage is proved if appropriate, and pedestrian links are direct and clear.

(ii) *Calculating parking space reductions.* Parking space reductions can be determined by a calculation using Table 4, Parking Occupancy Rates. If the calculation does show a parking space regulation reduction to be feasible, the applicant shall submit a parking reduction worksheet showing the process for calculating the reduction as outlined herein. The calculation using Table 4, Occupancy Rates shall be conducted as follows:

a. *Determine minimum spaces required.* The minimum number of parking spaces that are to be provided and maintained for each use shall be determined by using Table 3, Parking Ratios.

b. *Calculate occupancy rates.* The minimum number of parking spaces shall be multiplied by the "occupancy rate" (the percentage) provided in Table 4, Parking Occupancy Rates, for each use for the weekday night, daytime and evening periods, and weekend night, daytime and evening periods, respectively.

(iii) *Sum parking spaces.* Sum the parking spaces for the combined uses for each time period. The number of parking spaces from the time period with the highest calculated number of parking spaces shall be the number of spaces required for the shared parking facility

TABLE 4
Parking Occupancy Rates

(Percent of basic minimum needed during time period)

Uses	M-F 8am- 5pm	M-F 6pm- 12am	M-F 12am- 6am	Sat.& Sun. 8am- 5pm	Sat. & Sun. 6pm- 5pm	Sat. & Sun. 12am - 6am
Land Use Categories						
Residential	60%	100%	100%	80%	100%	100%
Commercial*	90%	80%	5%	100%	70%	5%
Office	100%	20%	5%	5%	5%	5%
Public & Institutional Uses (non- church)	100%	20%	5%	10%	10%	5%
Public & Institutional Uses (church)	10%	5%	5%	100%	50%	5%
Manufacturing/ Industrial	100%	60%	40%	50%	30%	10%
Warehouse/ Wholesale	100%	20%	5%	5%	5%	5%
Recreation	40%	100%	10%	80%	100%	50%
Specific Commercial Uses						
Hotel	70%	100%	100%	70%	100%	100%
Restaurant	70%	100%	10%	70%	100%	20%
Theater	40%	80%	10%	80%	100%	10%
Conference/ Convention	100%	100%	5%	100%	100%	5%

Source: Shared Parking Planning Guidelines, Institute of Transportation Engineers.

*Some specific uses have different occupancy rates. Check under "Specific Commercial Uses" with the rest of the table.

(4) Increases or reductions in excess of those identified herein shall be allowed only as a conditional use and shall be granted in accordance with Chapter 163, governing applications of conditional uses, procedures, and upon the finding that the increase or reduction is needed.

(Ord. 4567, 05-04-04; Ord. 4930, 10-03-06; Ord. 5118, 3-18-08; Ord. 5297, 12-15-09)

172.06 Parking Lot Location Standards

The location of all required and nonrequired parking lots with five (5) or more spaces shall meet the location requirements below. All conditional uses hereunder shall be granted by the Planning Commission in accordance with Chapter 163, governing applications of conditional uses; procedures.

(A) *Permitted locations by right.* Parking lots shall be located within the same zoning district as the use they serve. Required parking lots for uses allowed by right within a zoning district are allowed as a use by right in the same zoning district.

TITLE XV. UNIFIED DEVELOPMENT CODE

(B) *Permitted locations as a conditional use.*

- (1) Parking lots located within residential zones which serve uses in nonresidential zones may be allowed as a conditional use by the Planning Commission.
- (2) Parking lots for uses allowed as conditional uses within residential zones must also be approved as a conditional use. A conditional use for a parking lot may be approved at the same time the use is approved or may be approved separately if additional parking lots are developed later.

The Planning Commission shall make a finding based upon the size, scale, and location of these activities that the proposed parking lot will not adversely affect adjacent residential uses or the residential character of the neighborhood.

Cross reference(s)--Uses Conditions, Ch. 163.

(C) *Off-site locations.* If off-street parking cannot be provided on the same lot as the principal use due to existing buildings or the shape of the parcel, parking lots may be located on other property not more than 600 feet distant from the principal use, subject to conditional use approval by the Planning Commission.

(D) *Intermittent parking.* Uses which generate only intermittent demand for parking, such as churches, may count available on-street parking within 600 feet of the building as part of required parking, subject to the approval of the Planning Commission.

172.07 Reserved

(Ord. 4917, 09-05-06)

172.08 Nonconforming Parking Lots

All parking lots and/or parking areas which were in existence prior to the effective date of this ordinance

may continue in a nonconforming state until such time as the following shall occur:

(A) *Rehabilitation.* A building permit is granted to rehabilitate a structure on the property exceeding 50% of the current replacement cost of the structure. At such time, 50% of the existing parking lot use area shall be required to be brought into compliance with the provisions of this ordinance. This shall continue on a graduated scale in accordance with the percentage of rehabilitation cost; and/or

(B) *Enlargement or reconstruction.* A building permit is granted to enlarge or reconstruct a structure on the property exceeding 10% of its existing gross floor area. At such time 10% of the existing parking lot and/or parking lot area shall be brought into compliance with the provisions of this section. This shall be on a graduated scale until reaching 100% of the required landscaping; and/or

(C) *New curb cut.* A new curb cut permit is granted for the nonconforming parking lot. At such time the parking lot and/or parking area shall be required to be brought into compliance with the provisions of this ordinance.

Cross reference(s)--Variances, Ch. 156.

(Code 1965, App. A., Art. 8(9); Ord. No. 1747, 6-29-70; Ord. No. 2380, 9-20-77; Ord. No. 2549, 8-7-79; Code 1991, §160.117; Ord. No. 3870, §4, 2-21-95; Ord. No. 3962, §§1, 2, 4-16-96; Ord. No. 4100, §2 (Ex. A), 6-16-98; Ord. No. 4127, §1 (Ex. A), 12-15-98; Ord. No. 4319, 6-5-01; Ord. No. 4412, (Ex. A), 9-3-02)

172.09 Off-Street Loading

In all districts, accessory off-street loading berths, open or enclosed, shall be so arranged so that parking and maneuvering will occur on private property.

(Code 1991, §160.116; Ord. No. 4100, §2 (Ex. A), 6-16-98; Ord. 5296, 12-15-09; Ord. 5297, 12-15-09)

172.10 Bicycle Parking Rack Requirements

(A) *When bicycle parking racks are required.* All proposed new construction requiring twenty-five (25) off-street, automobile parking spaces or more shall require bicycle parking. All proposed or required expansions in automobile parking lots shall also meet the requirements of this ordinance.

(B) *Amount of bicycle parking racks required.* The following table shall be used to determine the minimum number of bicycle parking racks to be provided. (Note: each rack equals two bicycle parking spaces).

Total bicycle racks required	Equivalent total off-street automobile parking required by code in a non-residential development	Equivalent total off-street automobile parking required by code in a residential development
1	5-30	5-50
2	31-60	51-100
3	61-90	101-150
4	91-120	151-200
5	121-150	201-250
1 additional rack per/	Each additional 100 spaces	Each additional 150 spaces

(C) *Definition of a bicycle parking rack.* Each bicycle parking rack holds two bicycles. Each rack shall be an inverted U-type rack (as per specifications).

(D) *Spacing of racks.* Each bicycle parking space shall have 2' 0" x 6' x 0" clear space, paved or unpaved, beside the rack allowing each rack to potentially count as two spaces. The 2' 0" dimension may overlap another bicycle parking space such that racks positioned in a parallel row may be 2' 6" on center (See: Figure 1).

(E) *Position of bicycle parking racks.*

- (1) Bicycle parking racks should be located within 50 feet of a public entry.
- (2) Bicycle parking facilities should have adequate lighting for the operation of combination and key locks at night and to minimize theft.
- (3) Bicycle parking racks should be positioned so that no pedestrian traffic is impeded.
- (4) Bicycle parking racks should not be located within bus stops, loading zones, or other curb

space where on-street parking is permitted unless approved by the City Engineer.

- (5) Bicycle parking racks shall have a 15' 0" clearance from the edge of fire hydrants.
- (6) Bicycle parking racks should have a 4' 0" clearance from existing street furniture, including mailboxes and light poles.
- (7) Bicycle parking rack location shall not interfere with ADA standards.

(F) *Variations in requirements.*

- (1) *Shared bicycle parking.* Any property owner required to have bicycle parking may elect to establish a shared bicycle parking facility with any other property owner within the same block to meet the combined requirements.
- (2) *Rack configuration.* Custom bicycle parking racks may be permitted subject to Planning Division approval. Custom racks shall meet the material and embedment specifications in this chapter. Custom racks in the form of signage or corporate logos shall not be permitted.

(G) *Procedure for compliance.*

- (1) For projects requiring bicycle parking, the bicycle parking shall be indicated on the site plan that is submitted to the Planning Division for approval. All site plans must be drawn to scale.
- (2) Shared bicycle parking agreements that meet the requirements of this ordinance shall be automatically approved.

(H) *Specifications.*

- (1) *Design.* Each rack shall be an inverted U-type rack designed with either extended legs for embedment in concrete footing, or with steel flange for bolting onto paved surface. The apex of the U shall be 2' 9" - 3' 0" above the ground. The legs of the U-shape shall be 1' 6" on center.
 - (a) *With embedment.* The rack legs shall extend 9" into a concrete footing. Before applying finish, the pipe shall be drilled 3 inches above the base and fitted with a 6 inch long, 7/16 inch diameter steel cross bar. This cross bar shall be welded into place, lies horizontally and acts as an anchor.
 - (b) *With flange mount.* A pre-drilled, steel flange, minimum 8 inch square, shall be

TITLE XV. UNIFIED DEVELOPMENT CODE

welded to the bottom of each leg before final finish is applied. The flange shall have a minimum of three bolt holes. Each bolt hole shall accept a 1/2 inch diameter steel bolt.

- (2) *Materials.* Racks are to be constructed of 1 1/2 inch, Schedule 40 steel pipe (1.90" x 0.145" wall). The pipe shall be bent in one piece (not welded in sections).
- (3) *Finishes.* Unless the pipe material is stainless steel, the pipe shall have PVC coating, powdercoat finish or hot-dipped galvanized finish applied after the flange has been welded in place (Surface Mount Method) or the anchoring cross bar has been fitted in a drilled hole (Embedment Method).
- (4) *Anchoring the rack.* Paving is not required, however, racks shall be securely anchored through one of the two following methods:
 - (a) *With embedment.* The rack shall be embedded in a minimum of 9 inch diameter, 10 inch deep concrete footing. (See: Illustration--Embedded Anchor Mount)
 - (b) *With flange mount.* Racks shall be anchored with 3 inch anchor bolts, 1/2 inch in diameter. Mounting flange shall be a minimum 3/8 inch plate. (See: Illustration--Flanged Surface Mount).

Figure 1. Two racks spaced 2 feet 6 inches on center and equaling 4 parking spaces.

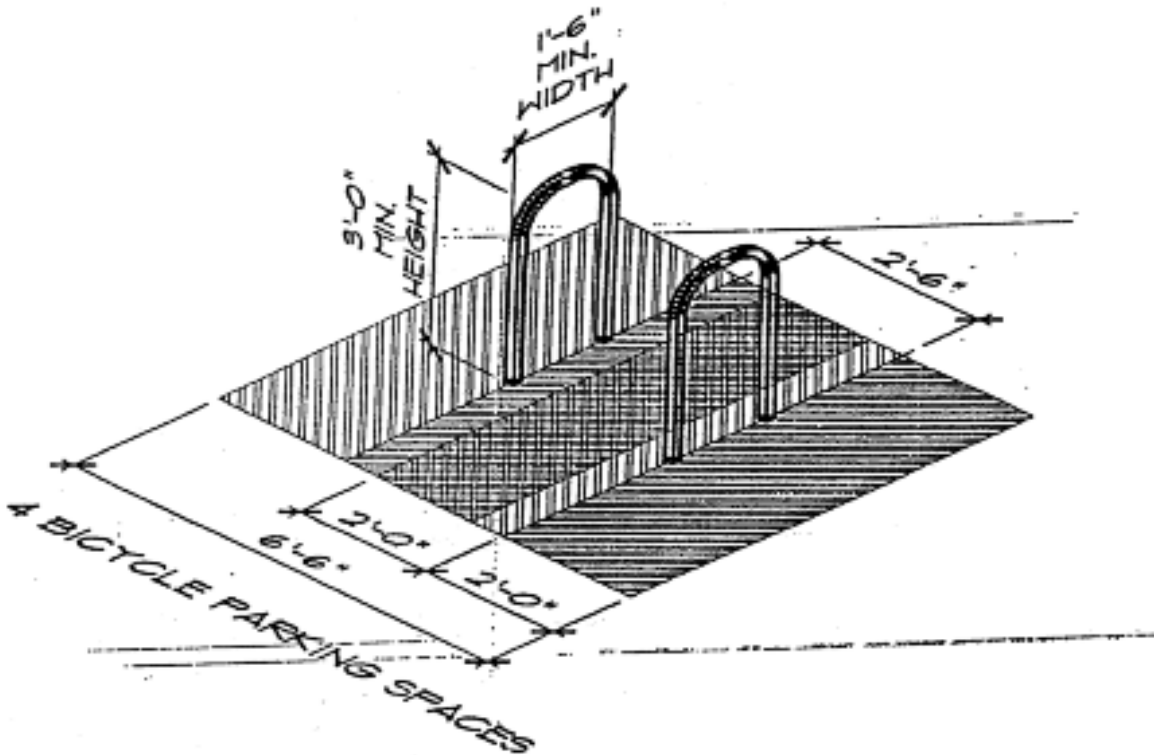

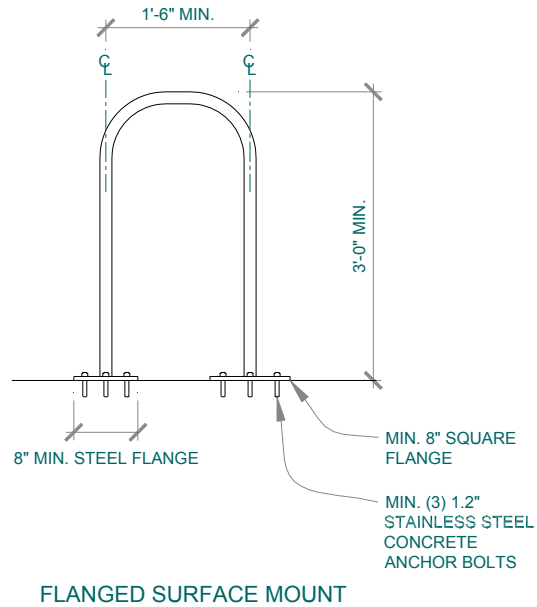
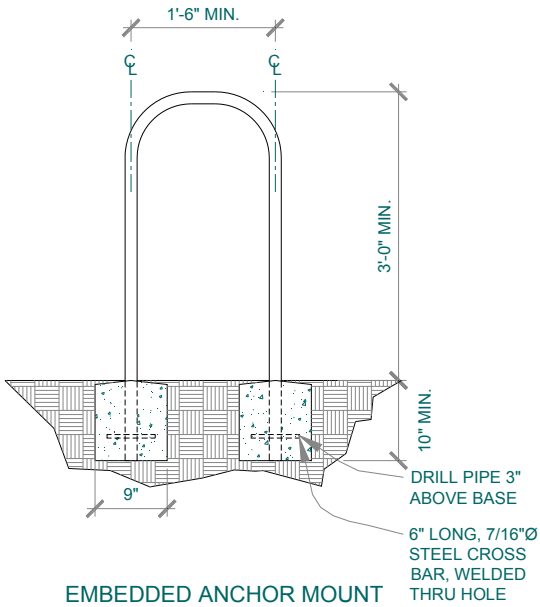

(Ord. No. 4293, 2-20-01; Ord. 5297, 12-15-09)

172.11 Driveway Design, Location, and Construction Standards for Four (4) or Less Spaces Parking Spaces within the Front Yard Area

(A) *Minimum Distance of Driveway and Parking from Street and into Property.*

- (1) *Driveway Approach to Property Line.* The driveway approach shall extend to the property line and/or master street plan right-of-way from the paved street and shall be designed, permitted, and paved with concrete in accordance with Chapter 171.13 Sidewalk and Driveway Specifications.
- (2) *Driveways Beyond the Property Line.* Driveways shall be paved from the property line and/or master street plan right-of-way with asphalt, concrete, brick or stone pavers, or other solid surface and shall extend 18 feet (length) into the property unless no parking is provided between the property line and structure.
- (3) *Driveways Beyond 18 Feet into the Property.* Driveways beyond 18 feet into the property may be paved or unpaved and shall be clearly defined by landscaping or edging.

(B) *Front Yard Area.* Front yard area shall mean the area between the plane of the front elevation of the principal façade(s) of the principal structure extending to the side property lines and the front property line abutting the street, including the driveway. A front shall be any plane of a building which abuts to a public street right of way.

(C) *Maximum Percent of Front Yard Area Used for a Driveway and Off-street Parking and Maximum Number of Parked Vehicles Allowed.* Driveways and off-street parking shall be limited to a maximum of four (4) vehicles and a maximum of 40% of the front yard area and shall meet the paving requirements as identified by this chapter.

(D) *Parking in Front Yard Area.* Parking of motor vehicles *recreational vehicles, trailers, and boats* in the front yard area of a property shall be prohibited, except in designated driveways or in a parking space as required by this chapter.

(E) *Off-street Parking on City Street Right-of-Way.* The off-street parking of any motor vehicle, boat, or trailer on a sidewalk or on city right-of-way and/or green space between the curb and property line shall be prohibited.

(F) *Unpaved Driveway Maintenance Requirements.* If an unpaved driveway is not maintained with adequate gravel, grasses, or other plants and/or landscaping materials to keep the area from becoming rutted, muddy and/or soil from being blown or washed away and is identified as a

TITLE XV. UNIFIED DEVELOPMENT CODE

violation of this provision, such driveway shall be immediately remedied by the property owner.

(G) *Driveway Grading and Drainage.* The driveway shall be graded in such a way to dispose of surface water into appropriate structures.

(H) *Maximum Width.* Maximum Driveway width shall be limited to:

Lot Width	Maximum Driveway Width
70 feet or more	24 feet
50 feet to 69 feet	20 feet
Less than 50 feet	18 feet

(I) *Loop or Circle Driveways.* Loop or circle driveways shall be allowed with a 50 foot separation as measured from the driveway edge between curb cuts, subject to other restrictions for driveway separations in the UDC.

(J) Exemptions to Parking in Front Yard Areas.

(1) *University of Arkansas Events.* Parking in the front yard area shall be allowed for a period of 12 hours before and 12 hours after a University of Arkansas event for persons attending said event on days when events are occurring at Bud Walton Arena or Donald W. Reynolds Stadium on the University Arkansas Campus.

(2) *Construction Vehicles.* Parking of vehicles for new construction and additions shall be allowed during the duration of the project.

(3) *Temporary Parking.* Temporary driveways or parking lots approved by the Planning Commission.

(4) *Existing Driveways.* All existing driveways constructed prior to adoption of these standards.

(5) *Special events.* Infrequent parking in the front yard for special events shall be allowed.

(Ord. 5044, 8-07-07)

172.12-172.99 Reserved

